

# Product Data Sheet

Power Terminals pitch 5.08 x 10.16 mm,  
Part No. 911-33049

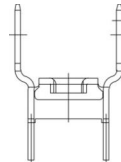
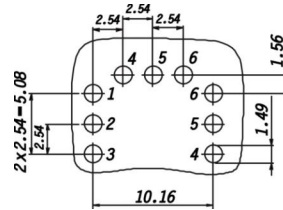

Illustration similar



Press-fit



Power



Rugged

- thread M4
- termination length 5 mm



» to product on [www.ept.de](http://www.ept.de)



» to product group Power Terminals

# Product Data Sheet

Power Terminals pitch 5.08 x 10.16 mm,  
Part No. 911-33049



---

## Technical Specifications

### Basics

---

Termination Technology	Press-fit
Termination Length	5 mm
Operating Temperature Range	-55°C to +125°C

### Material

---

Contact Material	Copper alloy
Plating	Sn

### Mechanical

---

Pitch	5.08 x 10.16 mm
-------	-----------------

### Electrical

---

Operational Current	20° 45A, 70° 30A, 100° 25A
---------------------	----------------------------

### Processing

---

Thread	M4
Max. Fastening Torque	1.3 Nm

### Approval / Compliance

---

Environment	RoHS compliant
-------------	----------------

# Product Data Sheet

Power Terminals pitch 5.08 x 10.16 mm,  
Part No. 911-33049



## Hole Specifications

Plated through-hole according to IEC 60352-5

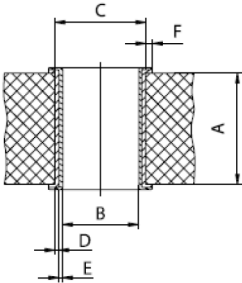

Material	chem. Sn Leiterplatten
<b>Nominal Hole</b>	<b>Ø 1.45 mm</b>
<b>A PCB Thickness</b>	min 2.9 mm
<b>B Plated Hole</b>	Ø 1.45 +0.09 / -0.06 mm
<b>C Drill Hole</b>	1.60 ±0.025 mm
<b>D Cu Plating</b>	min. 25 µm
<b>E Surface</b>	chem. Sn Schicht, max. 1.5 µm
<b>F Annular Ring</b>	min. 0.1 mm

Material	Ni, Au Leiterplatten
<b>Nominal Hole</b>	<b>Ø 1.45 mm</b>
<b>A PCB Thickness</b>	min 2.9 mm
<b>B Plated Hole</b>	Ø 1.45 +0.09 / -0.06 mm
<b>C Drill Hole</b>	1.60 ±0.025 mm
<b>D Cu Plating</b>	min. 25 µm
<b>E Surface</b>	Ni, Au Schicht, 0.05 - 0.2 µm Au über 2.5 - 5 µm Ni
<b>F Annular Ring</b>	min. 0.1 mm

Material	HAL Sn Leiterplatten
<b>Nominal Hole</b>	<b>Ø 1.45 mm</b>
<b>A PCB Thickness</b>	min 2.9 mm
<b>B Plated Hole</b>	Ø 1.45 +0.09 / -0.06 mm
<b>C Drill Hole</b>	1.60 ±0.025 mm
<b>D Cu Plating</b>	min. 25 µm
<b>E Surface</b>	HAL Sn, 5 - 15 µm
<b>F Annular Ring</b>	min. 0.1 mm

# Product Data Sheet

Power Terminals pitch 5.08 x 10.16 mm,  
Part No. 911-33049

---



## Accessories

» Power Terminals Socket cap screw DIN 84, M4  
Part Number 910-20145

» Power Terminals Philips screw  
Part Number 910-20146

» Power Terminals Washer  
Part Number 910-20320

## Drawings

Component data for this product you can request through [sales@ept.de](mailto:sales@ept.de)